

"a preferred name in load cell technology"

Model 30310

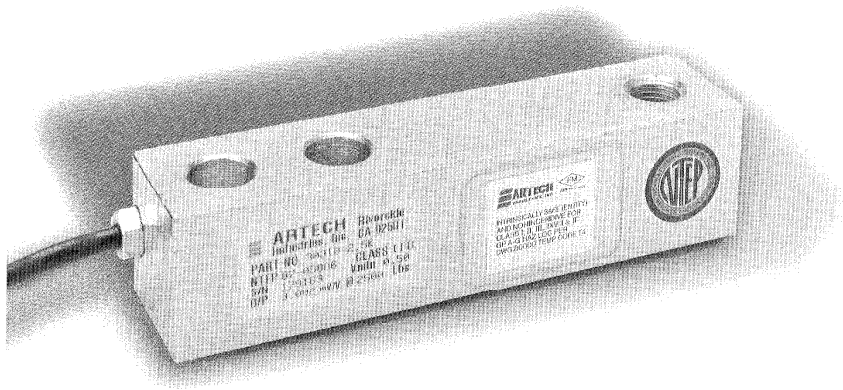

Rectangular Shear Beam Load Cell

FEATURES:

- Model 30310 threaded hole
- Model 30210 through hole
- 250 to 20K pounds capacities
- Complete environmental protection
- Stainless Steel versions available
- NTEP certified versions available for class III/ III L 5000 divisions
- Factory Mutual (F.M.) Approved †

NTEP C.O.C. #87-058A6

DESCRIPTION:

A versatile Load Cell designed for multiple use in low profile and platform scales, and in tank, bin, and hopper weighing systems. The high alloy steel construction ensures durability and precision performance. The cell is environmentally protected with waterproof seal and is nickel/chrome plated to assure resistance against corrosion. Mounting plates are also available (see accessories).

PERFORMANCE SPECIFICATIONS

Standard Capacities (lbs.):	*250, *500, 1K, 2K, 2.5K, 3K, 4K, 5K, 5KLE, 10K, 15K, 20K
Excitation Voltage:	10VDC - Maximum 15VDC
Rated Output:	3.0 mv/v + .25%
Non-Linearity:	< 0.03% FSO (Full Scale Output)
Hysteresis:	< 0.02% FSO
Non-Repeatability:	< 0.01% FSO
Zero Balance:	±1.0% FSO
Bridge Resistance:	350 ± 3.5 ohms
Safe Overload:	150% of Rated Capacity
Temperature:	
Compensated Range:	0 - 150 deg. F
Effect on Output:	< 0.0008% FSO/deg. F
Effect on Zero:	< 0.0011% FSO/deg. F
Finish:	Electroless Nickel/Chrome Plated
* Bending Beam	

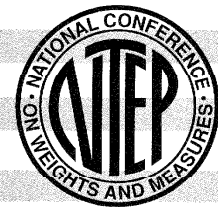

APPROVED

Model 30310



CAPACITY LBS.	PART NO.	A	B	C	D	E	F	G	H	I THREADS
250 - 5K	30310 - XX	5.12	1.25	1.25	.53	.60	1.00	3.00	.60	1/2-20 UNF - 2B
5KLE - 10K	30310 - XX	6.75	1.50	1.60	.78	.75	1.50	0.75	.75	3/4-16 UNF - 2B
15K - 20K	30310 - XX	8.75	2.00	2.00	1.03	1.00	2.00	4.75	1.00	1-14 UNF - 2B

ELECTRICAL TERMINATION
 INPUT OUTPUT SHIELD
 RED (+) GREEN (+)
 BLACK (-) WHITE (-)
COMPRESSION POSITIVE

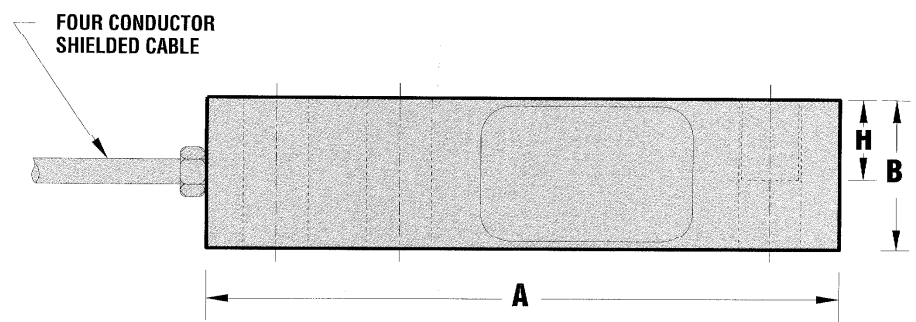
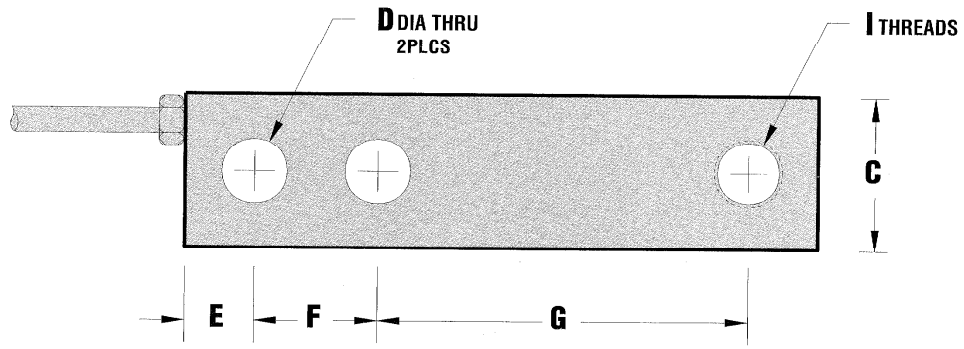

† Factory Mutual Systems approved as intrinsically safe when installed per F.M. approved installation drawing. Contact ARTECH sales department for details.

Represented by:



1966 Keats Drive, Riverside, CA 92501

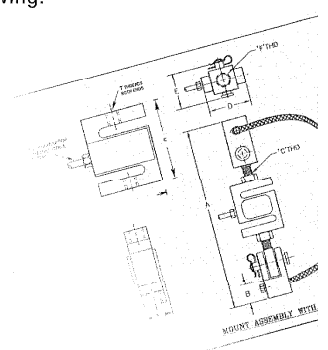

ORDER INFORMATION

- ◆ **ARTECH** is dedicated to maintaining adequate inventories of its Load Cells to provide the best service in the industry.
- ◆ Order by the model number and indicate the capacity required.
- ◆ Custom services such as matched load cell outputs, special threading, and custom calibrations are available on an optional basis at an extra cost.

Let us know what you need... we listen!
QUALITY • PERFORMANCE • SERVICE
 909-276-3331 • 800-654-8181 • Fax: 909-276-4556
 Email: artechind@msn.com • www.artech-loadcell.com